

INSTALLATION INSTRUCTION 0001-0839-999

Style 401 Couplings & Fittings

With Seal-Plus™ Restraining Ends

See other side for Nordstrom Polyvalve instruction

1. Cut tubing square and deburr. Tubing must be clean and free of longitudinal scratches. A slight chamfer approximately 1/16" x 45° on the end of tubing will facilitate insertion into the fitting.
2. Do not disassemble compression end(s).
3. Make sure nut flange is 1/4" to 5/16" from body contact.
4. Mark tubing for stab depth; 2-3/4" for 1/2" CTS (5/8" O.D.) thru 1" CTS (1-1/8" O.D.), 3" for 1-1/4" CTS (1-3/8" O.D.) and larger sizes.
5. Check stiffener to assure it is for wall thickness of tubing used (See the color code chart at right).
6. Stab tubing into fitting until it bottoms. If properly stabbed, the tube markings will be inside or not over 1/8" from the UNTIGHTENED nut. STABBING NOTE: This fitting does not grip when the tubing is stabbed. If difficulty is encountered in stabbing, withdraw the tubing and try reinserting again. (Be sure nut flange is at least 1/4" from body.) After proper stabbing is determined, THE NUT MUST BE HAND TIGHTENED TO ACTUATE THE GRIP RING FOR HOLDING THE TUBING IN PLACE DURING FINAL TIGHTENING.
7. Tighten nut while holding body octagon closest to nut until flange contacts body. (Do not overtighten.)
8. Check stabbing marks on tubing. If mark is over 9/16" from the tightened nut on 1/2" CTS (5/8" O.D.) thru 1" CTS (1-1/8" O.D.), and over 5/8" larger sizes, the end must be disassembled. After disassembly, check if stab mark length is correct. In reassembling an improperly stabbed end, cut off the tubing to eliminate the gripper teeth marks, reassemble parts in proper order, remark tubing, and then repeat the connection procedure.

NOTE: The gasket, spring washer and grip ring are held in place with shrink-wrap to facilitate assembly at the factory. The shrink-wrap does not need to be removed and is designed to break away during installation. However, if the fitting is disassembled following an improper installation, the shrink-wrap must be discarded prior to reassembly of the fitting as noted in Step 8 above.



Dresser™ Pipeline Solutions

41 Fisher Avenue
Bradford, PA 16701
P: 814.362.9200
F: 814.362.9344
www.dresserngs.com

© 2018 Natural Gas Solutions North America, LLC. The Dresser Logo and all Trademarks containing the term "Dresser" are the property Dresser, LLC, a subsidiary of Baker Hughes, a GE Company.

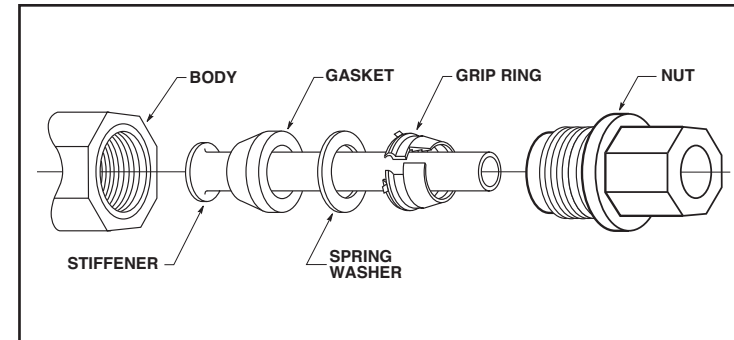

COLOR CODE CHART	
Tubing Wall (Any Diameter)	Stiffener Color
.062	Red
.077	Blue
.090	Silver
.099/.101/.103	Gold
.121	Black

NOTE:

2-3/4" Stab Length:
For 1/2" CTS (5/8" O.D.) thru 1" CTS (1-1/8" O.D.)

3" Stab Length:
For 1-1/4" CTS (1-3/8" O.D.) and larger.

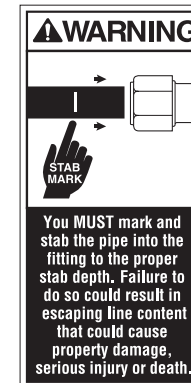

Part No. 0001-0839-999
11.2018

INSTALLATION INSTRUCTION 0001-0839-999

Style 401 Couplings & Fittings

With Seal-Plus™ Restraining Ends

STAB INSTALLATION INSTRUCTION

Recommendations for assembly of DRESSER Style 401 Couplings on Nordstrom Polyvalves

1. Installation must be within the dimensions shown in Figure 1 to recommend the use of the Dresser Style 401 coupling 1-1/4" CTS - 1-3/8" O.D. size.
2. When assembling on the Polyvalve end, the Style 401 coupling must be stabbed clear over the valve end until nut of 401 coupling is as close to the valve body as possible. This is to be sure the insert contacts the internal stop in the coupling body. (See Figure 2)
3. When tightening, rotate the body of the coupling keeping the insert in contact with the internal stop. Tightening will not require turning the fitting nut, only holding the nut during tightening.
4. Check stiffener to assure it is for wall thickness of tubing used (See the color code chart at right).
5. See reverse side installation instruction for all other typical 401 assemblies.

**SPECIAL
FOR
NORDSTROM
POLYVALVE™**

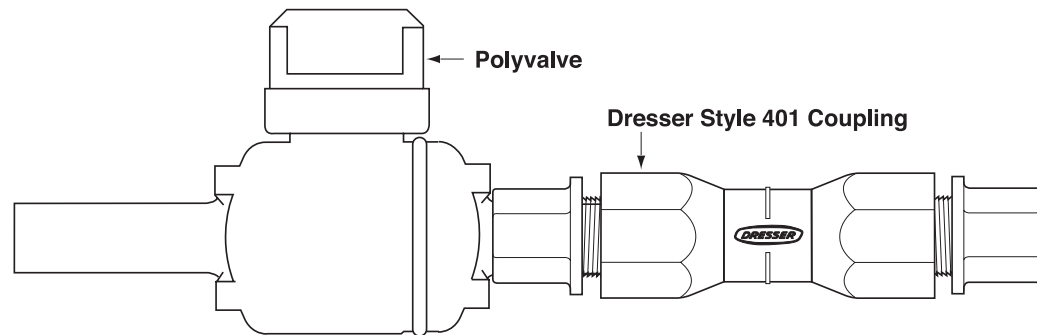
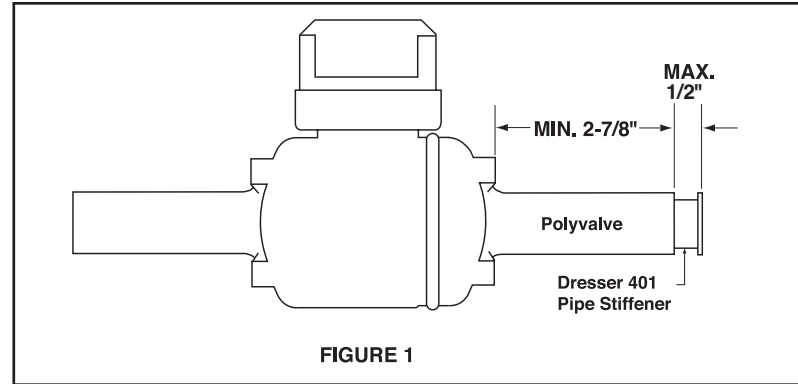

COLOR CODE CHART	
Tubing Wall (Any Diameter)	Stiffener Color
.062	Red
.077	Blue
.090	Silver
.099/.101/.103	Gold
.121	Black

WARNING

P.E. PIPE

CHECK SDR

Use proper insert in P.E. pipe end. Improper insert could result in escaping gas that could ignite and cause property damage, serious injury or death.



Dresser™ Pipeline Solutions

41 Fisher Avenue
Bradford, PA 16701
P: 814.362.9200
F: 814.362.9344
www.dresserngs.com

© 2018 Natural Gas Solutions North America, LLC. The Dresser Logo and all Trademarks containing the term "Dresser" are the property Dresser, LLC, a subsidiary of Baker Hughes, a GE Company.

Part No. 0001-0839-999

11.2018