

## INSTALLATION INSTRUCTION 0001-0830-999

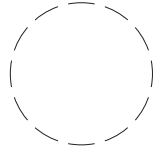

### Style 711 Insulating Line Caps

For Cast Iron Pipe

1. Clean CIP pipe end removing oil, dirt, loose scale, and rust; gasket should seat on bare metal.
2. For the purpose of proper pipe insertion into the line cap, mark pipe end as follows: For sizes 6" and smaller, the mark should be 4" from pipe end. For sizes 8" and 12", the mark should be 5-1/4" from pipe end.
3. Check inside of line cap to assure gasket, grip ring, insulating sleeve and plastic spacer ring are free of dirt or foreign matter.
4. After the gasket is clean, apply soap water to gasket and pipe end (anti-freeze should be added in freezing weather).
5. Without disassembling, stab line cap to mark on pipe.
6. Tighten nuts uniformly and evenly in a crisscross pattern, applying one or two turns to a nut at a time, up to a final torque of 80 ft. lbs. minimum (3"-8"); and 90 ft. lbs. minimum for 12".
7. Should field coating be desired, do not box coat with hot enamel coating.

#### CAUTION!

Never reuse this coupling for making a joint in accordance with D.O.T. Title 49 Part 192, Subpart F, Paragraphs 192.273(b), 192.283(b), & 192.285 unless grip ring, backup ring, gasket, bolts, nuts, and followers have been replaced OR the installer has determined these components have not been damaged in any way, are in new condition, and an applicable joining procedure is used.

When used for test purposes only, the installer shall determine conformance with Part 192 Subpart J, Paragraph 192.515(a).

Part No. 0001-0830-999  
12.2018

## INSTALLATION INSTRUCTION 0001-0830-999

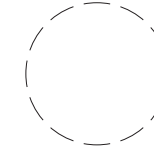

### Style 711 Insulating Line Caps

For Cast Iron Pipe

#### Product Ratings

Pipe Size Nom. (IN)	CIP Pipe Size O.D.	Max. Sealing Pressure (PSI)	Max. CIP Pipe Pullout Resistance
3	3.80	50 PSI	13000 lbs.
4	4.80	50 PSI	11000 lbs.
4	5.00	50 PSI	11000 lbs.
6	6.90	50 PSI	21000 lbs.
6	7.10	50 PSI	21000 lbs.
8	9.05	50 PSI	37300 lbs.
8	9.30	50 PSI	37300 lbs.
12	13.20	50 PSI	100,000 lbs

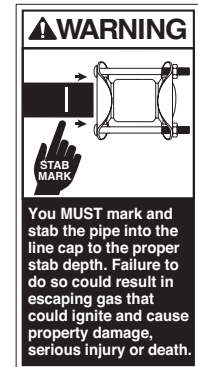

#### Dresser™ Pipeline Solutions

41 Fisher Avenue  
Bradford, PA 16701  
P: 814.362.9200  
F: 814.362.9344  
www.dresserngs.com

© 2018 Natural Gas Solutions North America, LLC. The Dresser Logo and all Trademarks containing the term "Dresser" are the property of Dresser, LLC, a subsidiary of Baker Hughes, a GE Company.

Part No. 0001-0830-999  
12.2018