

INSTALLATION INSTRUCTION 0001-0824-999

Style 711 Refurbishing Kit

New gaskets, grip rings, backup rings, nuts and bolts
For Steel or Polyethylene* Pipe

1. Disassemble coupling and discard all components (i.e. gaskets, grip rings, backup rings, bolts, nuts, etc.) except for middle ring & followers.
2. The I.D. of both flared ends of the middle ring must be free from rust, dirt, loose scale and grooves. The remaining areas of the middle ring must be free of deep corrosion pits, grooves, dents or other defects that would affect its structural integrity.
3. Check follower condition on taper and internal surfaces; there should be no imperfections or corrosion. Assure that there is no excessive wear caused by the nuts turning against the follower. Replace the followers, if necessary.
4. Remove the twist wires from both sub-assemblies.
5. Place one follower on a clean flat surface. Assemble grip ring into follower until the taper of the grip ring meets the taper of the follower.
6. On sizes having a loose backup ring, drop backup ring onto grip ring. On other sizes proceed to step #7.
7. Drop gasket into follower in the position depicted above.
8. Repeat steps 5 through 7 for other follower and sub-assembly. Assure that the components of both follower assemblies are in the correct order and orientation as depicted above.
9. Place one follower assembly on clean, flat surface with gasket side facing up. Place middle ring on follower assembly so it is centered on gasket.
10. Place other follower assembly on the middle ring so that the gasket is centered on the middle ring.

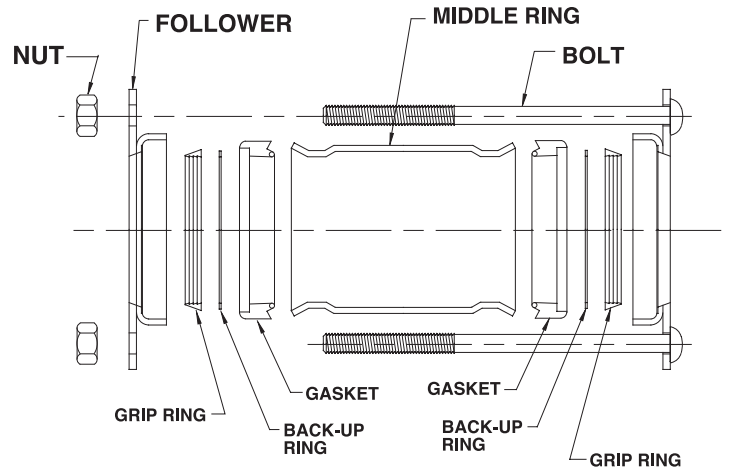

11. Assemble bolts through holes in followers and make nuts finger tight. Install branding side of nuts away from follower.

Install this product in accordance with the Installation Instructions enclosed.

* Always use the proper insert stiffener on P. E. pipe ends.

⚠ WARNING

IMPROPER ORIENTATION AND ASSEMBLY OF COMPONENTS COULD CAUSE COUPLING OR LINE CAP TO BLOW OFF THE LINE OR RESULT IN ESCAPING GAS THAT COULD IGNITE. EITHER CONDITION COULD CAUSE PROPERTY DAMAGE, SERIOUS INJURY OR DEATH.



CAUTION!

Never reuse this coupling for making a joint in accordance with D.O.T. Title 49 Part 192, Subpart F, Paragraphs 192.273(b), 192.283(b), & 192.285 unless grip ring, backup ring, gasket, bolts, nuts, and followers have been replaced OR the installer has determined these components have not been damaged in any way, are in new condition, and an applicable joining procedure is used.

When used for test purposes only, the installer shall determine conformance with Part 192 Subpart J, Paragraph 192.515(a).

DRESSER
NATURAL GAS SOLUTIONS
Dresser™ Pipeline Solutions
41 Fisher Avenue
Bradford, PA 16701
P: 814.362.9200
F: 814.362.9344
www.dresserngs.com

© 2018 Natural Gas Solutions North America, LLC. The Dresser Logo and all Trademarks containing the term "Dresser" are the property of Dresser, LLC, a subsidiary of Baker Hughes, a GE Company.

Part No. 0001-0824-999
12.2018