

# INSTALLATION INSTRUCTION 0001-0663-999

## Style 711 Reducing Coupling

### 4" O.D. X 4" I.D. (4-1/2" OD)

#### For Steel Pipe to Polyethylene Pipe

1. Clean steel pipe end removing oil, dirt, loose scale, and rust; gasket should seat on bare metal. Pipe ends must be cut square and polyethylene pipe must be free of dirt, longitudinal scratches, grooves and burrs.
2. On the P. E. pipe end, the recommended insert stiffener must be installed. Before inserting in pipe end, each insert should be checked to ensure that the SDR indicated on the insert branding corresponds to the SDR of the pipe being used.
3. Install proper insert in the P. E. pipe end.
4. For the purpose of proper pipe insertion in coupling, mark each pipe end 4" from end of pipe.
5. Check inside of coupling to assure gaskets and grip rings are free of dirt or foreign matter.
6. After gaskets are clean, apply soap water to gaskets and pipe ends (anti-freeze should be added in freezing weather).
7. Without disassembling, stab coupling up to mark on pipe.
8. Stab P. E. pipe end into coupling up to mark on pipe.
9. Tighten nuts uniformly and evenly in a crisscross pattern until all bolts are at 80 Ft. Lbs. torque.
10. Should field coating be desired, do not box coat with hot enamel coating.

**NOTE:** The pipe joint using this coupling must be considered rigid, non-flexible connection.

#### Product Ratings for Style 711 Reducing Coupling

Pipe Size OD X OD (IN)	Max. Sealing Pressure (PSI)	Max. Steel Pipe Pullout Resistance	Polyethylene Pipe* Pullout Resistance up to Max. wall listed in table meets or exceeds the requirements as specified in DOT 192.283 (b). (See Notes 1&2)	
			Type 2306/2406	Type 3406/3408
4.00 x 4.50	150 PSI	9000 lbs.	SDR 9.3	SDR 9.3

Note 1 - For wall thickness greater than SDR listed, contact Dresser for recommendation.

Note 2 - Pullout resistance is based on using reinforcing pipe inserts that conform to Dresser specifications.

Note 3 - Pipe joint using this coupling must be considered a rigid, non-flexible connection

\*Polyethylene Pipe Listed in ASTM-D2513

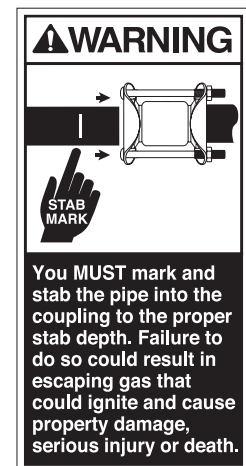
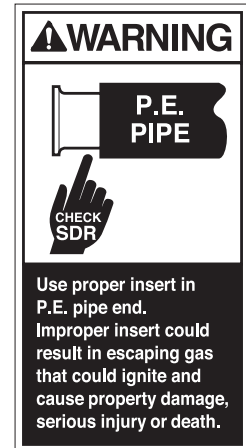

**CAUTION!**

Never reuse this coupling for making a joint in accordance with D.O.T. Title 49 Part 192, Subpart F, Paragraphs 192.273(b), 192.283(b), & 192.285 unless grip ring, backup ring, gasket, bolts, nuts, and followers have been replaced OR the installer has determined these components have not been damaged in any way, are in new condition, and an applicable joining procedure is used.

When used for test purposes only, the installer shall determine conformance with Part 192 Subpart J, Paragraph 192.515(a).



#### Dresser™ Pipeline Solutions

41 Fisher Avenue  
Bradford, PA 16701  
P: 814.362.9200  
F: 814.362.9344

www.dresserngs.com

© 2018 Natural Gas Solutions North America, LLC. The Dresser Logo and all Trademarks containing the term "Dresser" are the property of Dresser, LLC, a subsidiary of Baker Hughes, a GE Company.

Part No. 0001-0663-999  
12.2018